



RPC™ Radial Piston Crimping Tool

Volant’s RPC™ tool is a hydraulically driven load controlled crimping tool used to apply radial load in crimping and swaging applications. The RPC is portable and built for field applications. The patented split housing architecture makes it possible to easily position the crimper anywhere along the sections on the pipe. With a full one inch diametric stroke, the interchangeable crimp jaws allow variable curvatures and lengths that accommodate special geometry requirements.

Base Tool Characteristics

Maximum Working Pressure	psi (MPa)	10,000 (68.9)
Working Crimp Force	lbs (kN)	801,000 (3,500)
Diametrical Clearance	in. (mm)	6.75 (171)
Diametrical Stroke	in. (mm)	1.02 (25.9)
Length of Dies	in. (mm)	3.85 (98)
Tool Height without Frame	in. (mm)	17.9 (453)
Tool Height with Frame	in. (mm)	25.2 (640)
Base Tool Weight	lbs (kg)	290 (132)
Number of Pistons		6

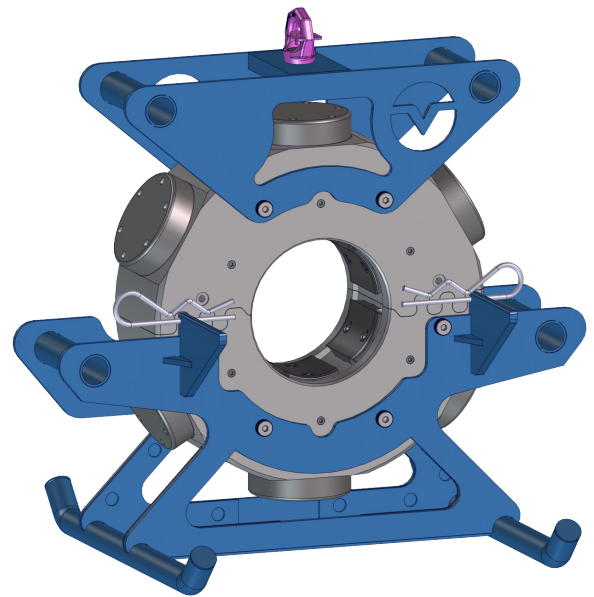

Crimp Jaw Part No. ¹	Diametrical Die Curvature		Maximum Crimp Clearance		Tool Weight ²	
	(in.)	(mm)	(in.)	(mm)	(lbs)	(kg)
80755	5.30	134.6	5.88	149.0	300	137
80756	4.17	105.9	4.76	121.0	307	140
80757	3.07	77.9	3.67	93.0	318	145
82274	4.39	111.5	4.97	126.0	306	139

1. Current crimp jaws shown. Custom crimp jaws are available upon request.
2. Tool weight does not reflect hoses or hydraulic fittings.

*Volant® is a registered trademark of Volant Products Inc. RPC™ is a trademark of Noetic Technologies Inc.

